

## \$0 - 14045 156 Street, Edmonton

MLS® #E4421452

**\$0**

0 Bedroom, 0.00 Bathroom,  
Industrial on 0.00 Acres

Mistatim Industrial, Edmonton, AB

The property is 6,400 sq.ft.± of Office/Warehouse Space. It features both grade and dock loading. Conveniently located just off 137 Avenue and 156 Street, the site offers quick access to major routes, including St. Albert Trail, Yellowhead Trail, and Anthony Henday Drive. This property is ideal for businesses in manufacturing, transportation and logistics, retail showrooms, and more.

Built in 2017

### Essential Information

|            |            |
|------------|------------|
| MLS® #     | E4421452   |
| Bathrooms  | 0.00       |
| Acres      | 0.00       |
| Year Built | 2017       |
| Type       | Industrial |
| Status     | Active     |

### Community Information

|             |                     |
|-------------|---------------------|
| Address     | 14045 156 Street    |
| Area        | Edmonton            |
| Subdivision | Mistatim Industrial |
| City        | Edmonton            |
| County      | ALBERTA             |
| Province    | AB                  |
| Postal Code | T6V 1J1             |

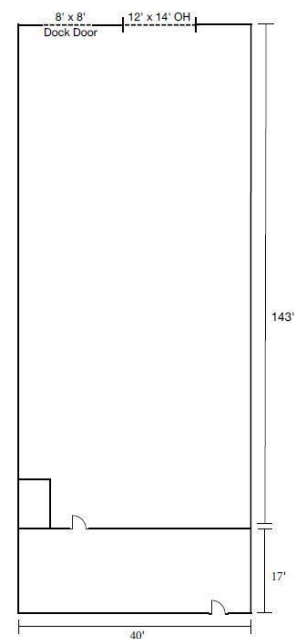

**Exterior**

|              |       |
|--------------|-------|
| Exterior     | Mixed |
| Construction | Mixed |

**Additional Information**

|                |                     |
|----------------|---------------------|
| Date Listed    | February 13th, 2025 |
| Days on Market | 65                  |
| Zoning         | Zone 40             |

DATA IS DEEMED RELIABLE BUT IS NOT GUARANTEED ACCURATE BY THE REALTORS® ASSOCIATION OF EDMONTON. COPYRIGHT 2025 BY THE REALTORS® ASSOCIATION OF EDMONTON. ALL RIGHTS RESERVED.Trademarks are owned or controlled by the Canadian Real Estate Association (CREA) and identify real estate professionals who are members of CREA (REALTOR®, REALTORS®) and/or the quality of services they provide (MLS®, Multiple Listing Service®)

Listing information last updated on April 19th, 2025 at 6:02am MDT